

USER MANUAL

Thank you for choosing our miniBatt ST. Always follow basic safety precautions when using electrical appliances. Read all instructions carefully, and keep this instruction manual for easy reference.

MODEL : miniBatt ST

A. PRODUCT LAYOUT:

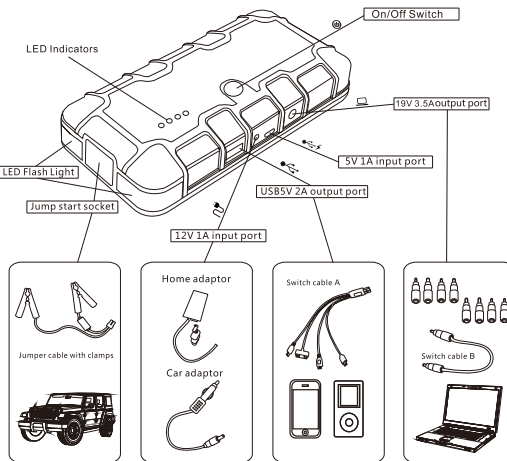

ENGLISH

B. OPERATION GUIDANCE

Indicator

Press the switch to check is storage level of Jump Starter

Indicator	1 solid	2 solid	3 solid	4 solid
Storage level	25%	50%	75%	100%

The indicator will flash one by one during the period of charging. Different number of solid indicators show different storage level of Jump Starter. All indicators light up when the charging the paused or completed.

Jump Starter Charging Instruction:

1. Plug the home adaptor into the universal socket.
 2. Connect 12V 1A input port of Jump Starter to the other end of home adaptor.
- Or
1. Plug the car adaptor into the socket of cigarette lighter.
 2. Connect 12V 1A input port of Jump Starter to the other end of car adaptor.
- Or
1. Plug the USB cable to electronic devices with USB output.
 2. Connect 5V/1A input port to start charging.

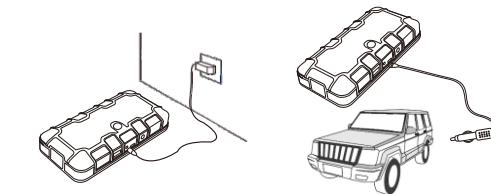

Jump start 12V vehicle instruction:

1. Make sure that the number of indicators is not less than 3.
2. Connect the RED clamp to the vehicle's battery positive (+) terminal and connect the BLACK clamp to the vehicle's battery negative (-) terminal.
3. Plug the cord of jumper cable into the jump start socket.

ENGLISH

4. Start the vehicle

5. When the vehicle is started, remove jumper cable from Jump Starter and disconnect red and black clamps to the vehicle battery terminals within 30 seconds.

6. Leave the vehicle's engine running

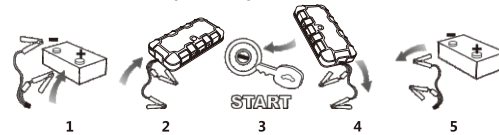

Charging Cell Phone or Tablet Instruction:

1. Plug the switch cable B to USB 5V 2A output port.
2. Select appropriate connector for your cell phone or tablet and connect it to any of them, Jump Starter can identify and charge the electronic device automatically. The indicators will be on when the device is charging.
3. Press the switch button to charge.

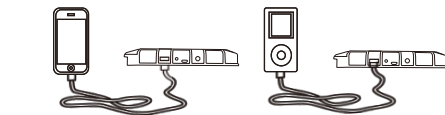

Power Supply for 19v Notebook

1. Plug the switch cable B to 19V 3.5A output port.
2. Select appropriate connector for your notebook and connect it to the switch cable B and your notebook.
3. Press the switch button to supply power for 19v notebook



ENGLISH

LED flash light

Press the switch 3 seconds to start the LED flash light.

There are 4 modes of LED light appear in order(normal.strobe.SOS .off)if you press slightly.

C. PARTS LIST:

#	Parts Name	Quantity	#	Parts Name	Quantity
1	Host	1	5	Home adaptor	1
2	Switch cable A	1	6	Car adaptor	1
3	Switch cable B	1	7	User Manual	1
4	Jumper Clamps	1	8		

D. TECHNICAL SPECIFICATIONS:

Size : 170*82*32 mm
Weight : 408g
Output: 5V \approx 2A; 19V \approx 3.5A; 12V Jump Start
Input : 12V \approx 1A; 5V \approx 1A
Full charging time : 5 hours
Starting current : 200A
Peak current : 400A
Operating temperature : -20°C ~ 60°C ~ 4F ~ 120F
Storage Temperature: Less than 70°C

E. FAQ:

Q. How to turn off this appliance?

A. This appliance will power off automatically when no load or charging is complete

ENGLISH

Q. How many times can this appliance charge for my cell phone?
A. 7 times for Iphone 4 mobile phone.

Q. How long will this appliance take to charge my mobile phone full?
A. Approx. 1 hour

Q. How long will this appliance on a full charge take to supply the Notebook?
A. 2-3 hours.

Q. How many times can this appliance on a full charge to start the vehicle?
A. Approx. 20 times.

Q. How long will the power of battery of this appliance remain?
A. 3-6 months, however, we suggest to recharge it every 3 months.

F. TROUBLE SHOOTING:

Finding	Cause	Remedies
No response when pressing the switch button.	Low voltage protection of Jump Starter is started.	Plug the adaptor into the 12V 1A input port to activate.

G. TOXIC AND HARMFUL SUBSTANCES:

Composition and amount of toxic and harmful substance in Jump Starter					
Pb	Hg	Cd	Cr(VI)	PBB	PBDE
0	0	0	0	0	0

0: Indicate all homogeneous materials's hazardous substances content are below the MCV limit specified in the standard 2002/95/EC (RoHS)

ENGLISH

H. Warning:

1. DO remove the product from the vehicle within 30s
2. DO NOT connect the two clamps. Otherwise, it may be dangerous!
3. DO NOT disassemble the host. Otherwise, it may be dangerous!

Q. How long will this appliance on a full charge take to supply the Notebook?
A. 2-3 hours.

Q. How many times can this appliance on a full charge to start the vehicle?
A. Approx. 20 times.

Q. How long will the power of battery of this appliance remain?
A. 3-6 months, however, we suggest to recharge it every 3 months.

- ⚠ Always take care when using the appliance
- ⚠ This appliance is not intended for use by young or infirm persons without supervision
- ⚠ Do not use as a toy
- ⚠ Do not allow the appliance to become wet
- ⚠ Do not immerse the appliance in water
- ⚠ Do not operate the appliance in explosive atmospheres, such as in the presence of flammable liquids, gases or dust
- ⚠ Do not modify or disassemble Jump Starter. Only a repair technician may repair this unit
- ⚠ Do not expose the appliance to heat
- ⚠ Do not store in locations where the temperature may exceed 70°C
- ⚠ Charge only at ambient temperatures between -20°C-60°C
- ⚠ Charge only using the charger provided with the appliance
- ⚠ Under extreme conditions, battery leakage may occur. Carefully wipe the liquid off using a cloth and avoid skin contact when you notice liquid on the batteries. In case of skin or eye contact, rinse immediately with clean water and seek medical attention
- ⚠ At the end of their useful life, discard the appliance with due care for our environment

ENGLISH

I. WARRANTY INFORMATION:

1. We offer a limited warranty for this product against any defects in material and workmanship for a period of 6 months from the date of purchase by the end user/consumer. The conditions of the warranty are as follows

2. The warranty is only valid upon presentation of the original receipt (from dealer/retailer) by the original purchaser with the product to be repaired or replaced

3. The warranty is void if the serial number, date of purchase and label has been removed

4. The warranty does not cover damage or product failure resulting from normal wear and tear, physical abuse, improper installation, misuse, modification or repairs by unauthorized third parties

5. We do not assume responsibility for any loss or damage incurred during shipment or as a result of a force majeure

6. We are not liable for any incidental or consequential damages arising from the use or misuse of the product

7. All warranty claims are limited to repair or replacement of the defective product and at the sole discretion of us

8. If we repair or replace the product, the product will be covered for the remaining time of the original warranty period. Repair or replacement may involve the use of reconditioned units which are equivalent in function. Replaced part or product becomes the property of us.

9. Consumable components such as batteries are not covered by the warranty.



Applied Standard: GB/T 18287-2000



IMPORTED BY :
TURISPORT, SL - Avda. Sant Julià 159-167
08403 Granollers - BARCELONA (SPAIN)
CIF : B-08882151 / www.miniBatt.com

ENGLISH