

# 20S Quick Start Guide

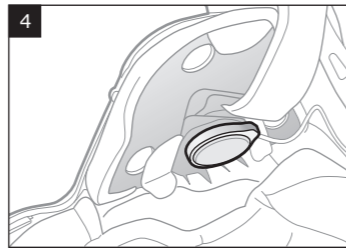

## Installation

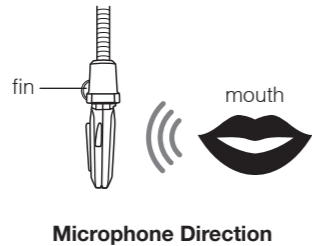
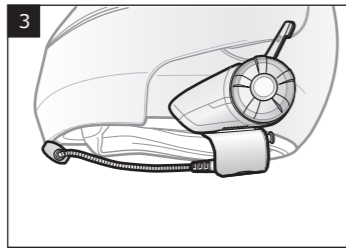
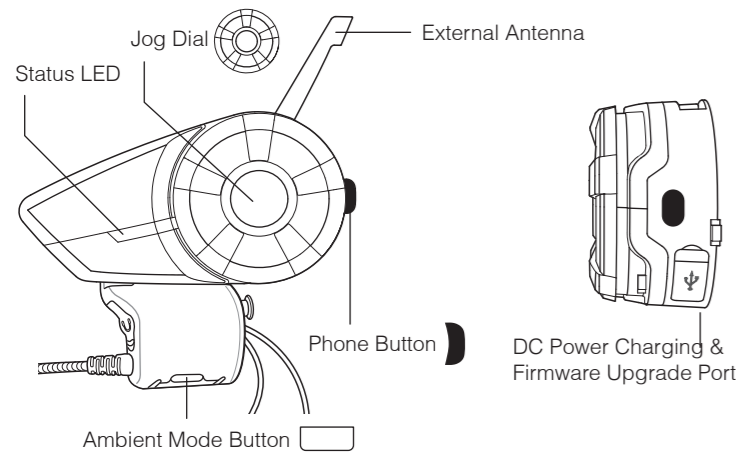
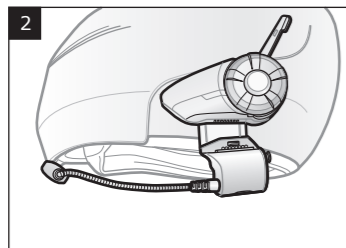
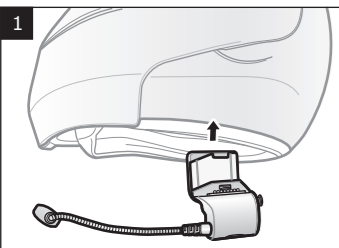

## Button Operation

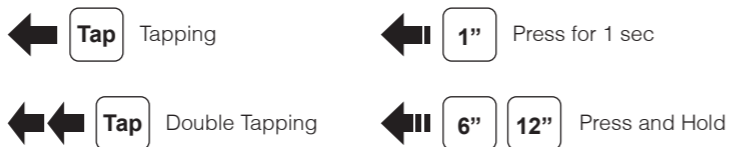

## Power On/Off

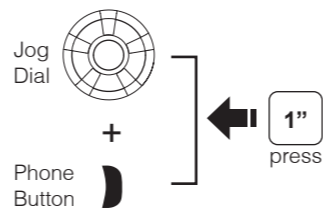

## Volume Adjustment

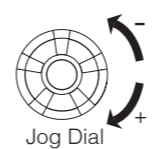

## Ambient Mode



## Bluetooth Pairing Phone, MP3 and GPS

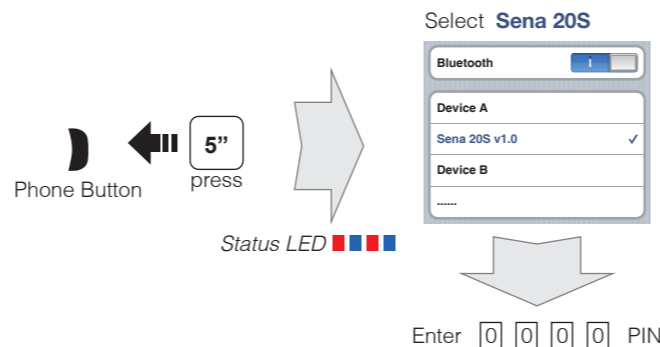

## Mobile Phone

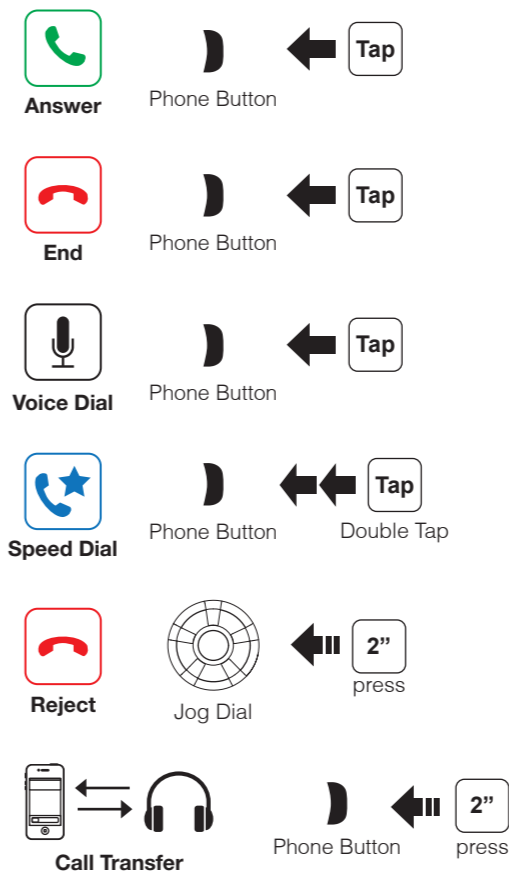

## Music

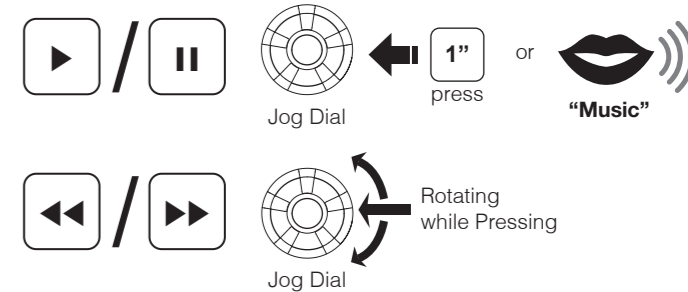

## Battery Check

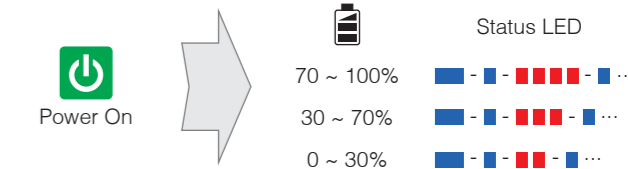

## Configuration Menu

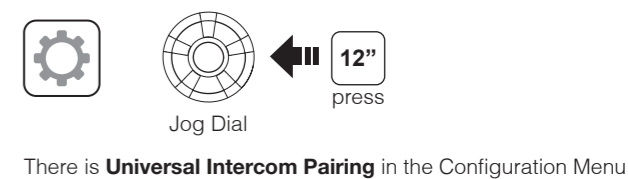

## Quick Pairing Intercom

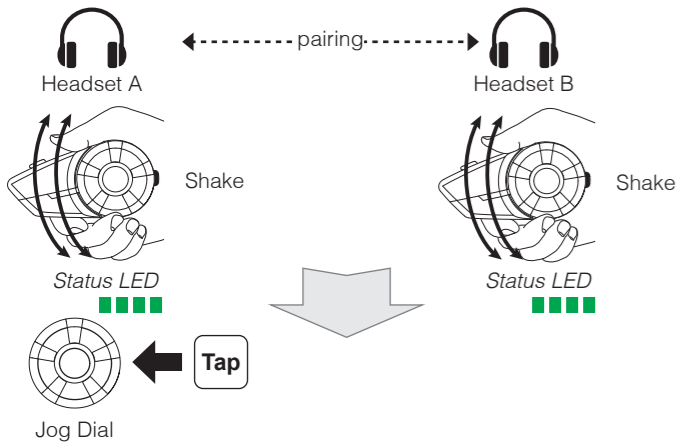

## Normal Pairing Intercom

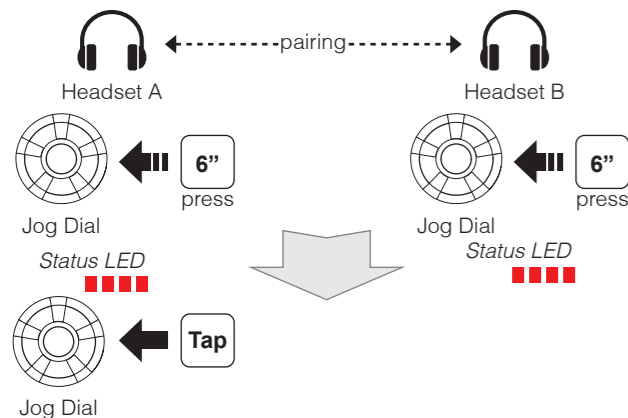

## Start / End Intercom

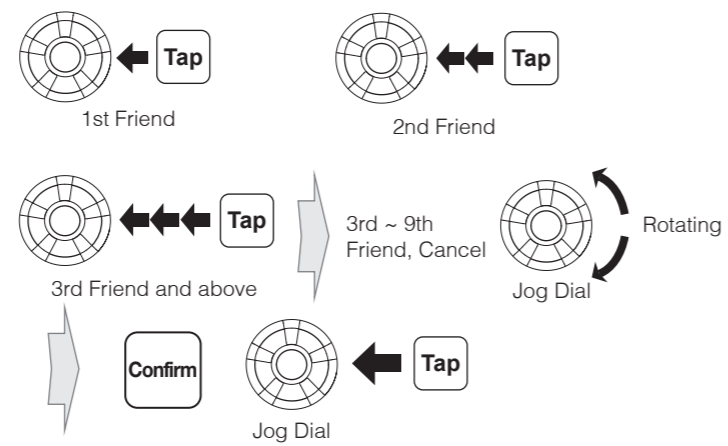

## Start / End Group Intercom

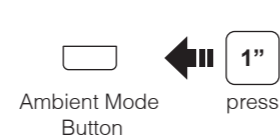

## Radio On / Off



## Radio Seek Stations



## Radio Scan Up FM Band

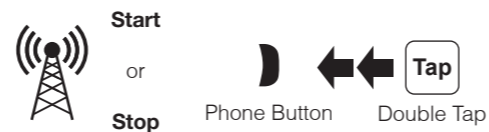

Save to preset while scanning



## Radio Save or Delete Preset

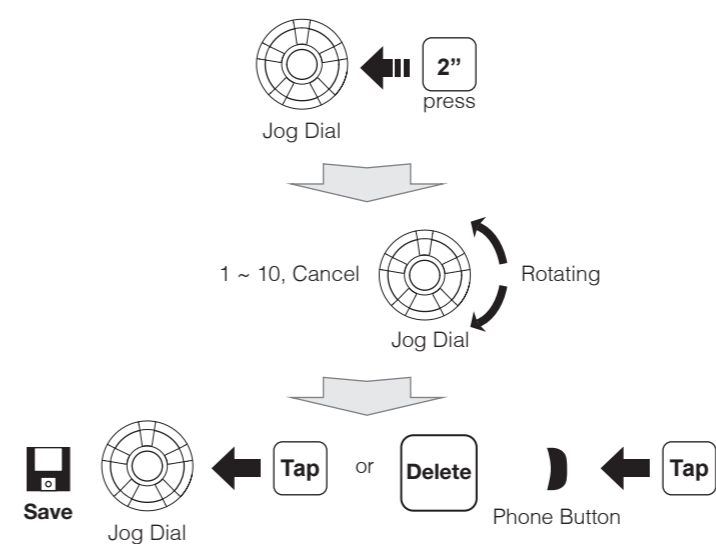

## Radio Move to Preset Station

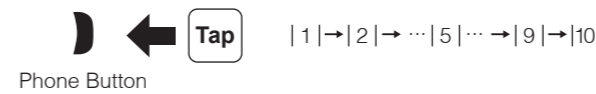

## Voice Command

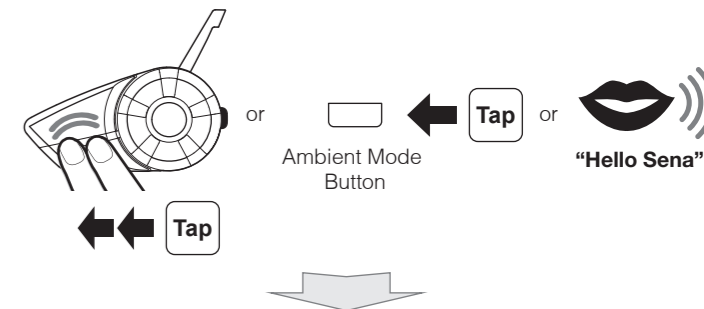

Voice Command	Function
"Music"	Music play/pause
"FM radio"	FM Radio on/off
"Intercom [one, two, ... , nine]"	Start/End each intercom
"Speed dial [one, two, three]"	Speed dialing

A full version of the manual is downloadable at [www.sena.com](http://www.sena.com).

**SENA** Sena Technologies, Inc.  
[www.sena.com](http://www.sena.com)  
 Customer Support : [support.sena.com](mailto:support.sena.com)  
 Tel : 408-300-9797 E-mail : [support@sena.com](mailto:support@sena.com)