

ATTACCHI SPECIFICI PER - SPECIFIC FITTING KIT FOR
 KIT DE MONTAGE SPECIFIQUE POUR - SPECIFISCHER MONTAGEKIT FÜR
 ANCLAJE ESPECÍFICO PARA

APRILIA SCARABEO 250 (06-07)

ISTRUZIONI DI MONTAGGIO - MOUNTING INSTRUCTIONS
 INSTRUCTIONS DE MONTAGE - BAUANLEITUNG - INSTRUCCIONES DE MONTAJE

1



SUPPORTO
 SUPPORT
 SUPPORT
 HALTERUNG
 SOPORTE

Q.TY n.2(Dx-Sx)

2



VITE TCEI M8x35mm
 SCREW M8x35mm
 VIS M8x35mm
 SCHRAUBE M8x35mm
 TORNILLO M8x35mm

Q.TY n.2

3



VITE TBEI M6x25mm
 SCREW M6x25mm
 VIS M6x25mm
 SCHRAUBE M6x25mm
 TORNILLO M6x25mm

Q.TY n.4

3



BOCCOLA DI RITENZIONE Z871N
 PLASTIC BUSH
 DOUILLE PLASTIQUE
 PLASTIK BÜCHSE
 CASQUILLO

Q.TY n.4

4

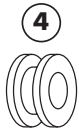

GOMMINO Z268
 FAIRLEADER
 CHAUMARD
 GUMMI
 GOMA

Q.TY n.4

6



DADO A.B. M6 FLANGIATO
 BOLT M6
 ECROU M6
 MÜTTERCA M6
 TUERCA M6

Q.TY n.4

7

AIRSTAR 130A
Q.TY n.-

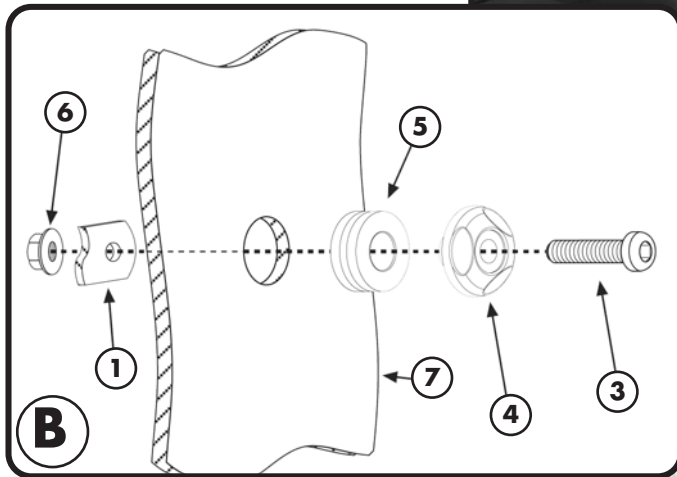

ATTACCHI SPECIFICI PER - SPECIFIC FITTING KIT FOR
KIT DE MONTAGE SPECIFIQUE POUR - SPEZIFISCHER MONTAGEKIT FÜR
ANCLAJE ESPECÍFICO PARA

APRILIA SCARABEO 250 (06-07)

ISTRUZIONI DI MONTAGGIO - MOUNTING INSTRUCTIONS
INSTRUCTIONS DE MONTAGE - BAUANLEITUNG - INSTRUCCIONES DE MONTAJE

I ISTRUZIONI DI MONTAGGIO

- RIMOVERE I DUE TAPPINI ORIGINALI SUL MANUBRIO.
MONTARE IL SUPPORTO "1" COME INDICATO IN FIGURA "A".
SEGUIRE IL MONTAGGIO DEL PARABREZZA 130A (NON INCLUSO) INDICATO IN FIGURA "B".
SERRARE TUTTE LE VITI.

GB MOUNTING INSTRUCTIONS

1. REMOVE THE TWO ORIGINAL CAPS ON THE HANDLEBARS.
2. MOUNT THE SUPPORT "1" AS SHOWN IN FIGURE "A".
3. FOLLOW THE INSTALLATION OF THE WINDSCREEN 130A (NOT INCLUDED) INDICATED IN FIGURE "B".
4. TIGHTEN ALL THE SCREWS.

F INSTRUCTIONS DE MONTAGE

1. ENLEVER LES DEUX CACHES D'ORIGINE SUR LE GUIDON.
2. MONTER LE SUPPORT "1" COMME INDiqué EN PHOTO "A."
3. SUIVRE L'ASSEMBLAGE DU PARE-BRISÉ 130A (NON INCLUS) INDiqué EN ILLUSTRATION "B."
4. SERRER TOUTES LES VIS.

D BAUANLEITUNG

1. ENTFERNEN SIE DIE 2 ORIGINALSTÖPSEL AUF DEM LENKER.
2. MONTIEREN SIE DIE HALTERUNG „1“ WIE IM BILD A HINGEWIESEN.
3. MONTIEREN SIE DIE SCHEIBE 130A (NICHT ENTHALTEN) WIE IM BILD „B“ GEZEIGT.
4. ZIEHEN SIE ALLE SCHRAUBEN FEST.

ES

INSTRUCCIONES DE MONTAJE

DESMONTAR LOS DOS TAPONES ORIGINALES SITUADOS SOBRE EL MANILLAR.
MONTAR EL SOPORTE "1" COMO SE INDICA EN LA FIGURA "A"
SEGUIR CON EL MONTAJE DEL PARABRISAS 130A, no INCLUIDO, INDICADO EN LA FIGURA "B."
APRETAR TODOS LOS TORNILLOS